



271A Oak Point Highway

Industrial (+/-) 1,800 SF

Location: Located on a major trucking route with excellent exposure facing the north side of Oak Point Highway.

Highlights:

- Grade level loading
- Good parking
- Professionally managed
- Available February 1, 2012

Zoning: C3

Lease Rate: \$5.00 per sf Net

CAM/Taxes: \$3.23 per sf (2012 est.)

Murray Goodman

Sales & Leasing Associate
murray.goodman@dtzbarnicke.com

Direct Tel: 204 928 5009

Cell: 204 990 4800

DTZ Barnicke Winnipeg Ltd.

Sterling Lyon Business Park
Unit 5— 986 Lorimer Boulevard
Winnipeg, Manitoba R3P 0Z8

Tel: 204 928 5000

Cell: 204 990 4800

Fax: 204 928 5010

www.dtzbarnicke.com

Tel: 204 928 5000

Although the information contained within is from sources believed to be reliable, no warranty or representation is made as to its accuracy being subject to errors, omissions, conditions, prior lease, withdrawal or other changes without notice and same should not be relied upon without independent verification.
DTZ Barnicke Winnipeg Ltd. 2012

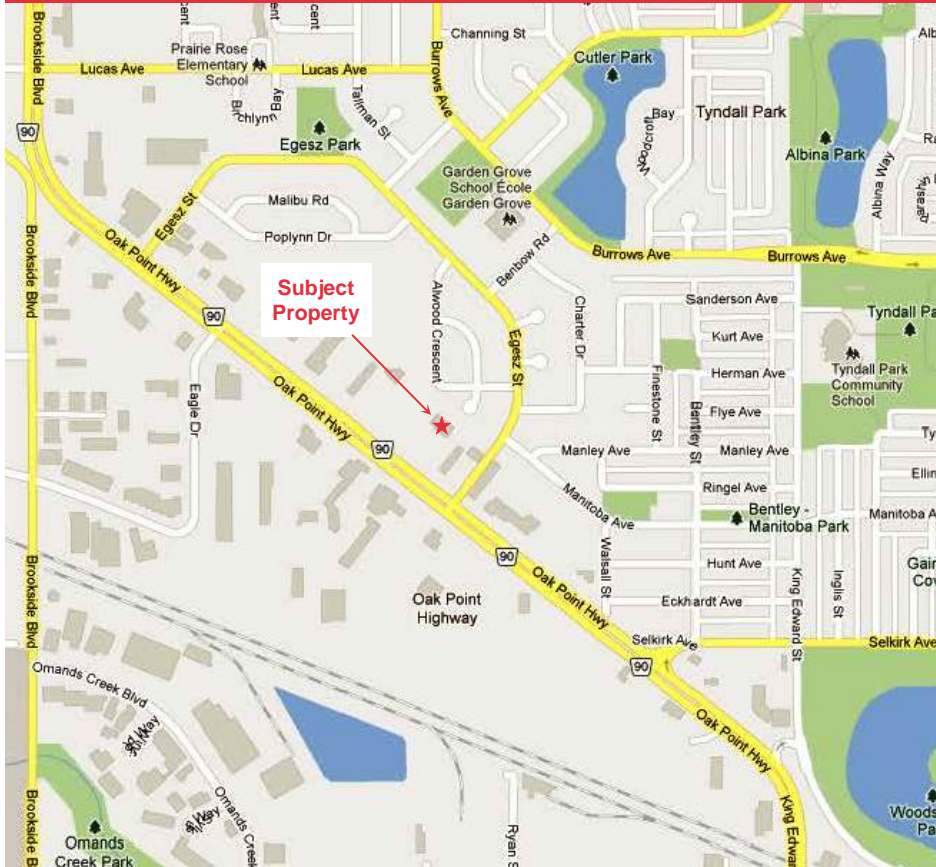
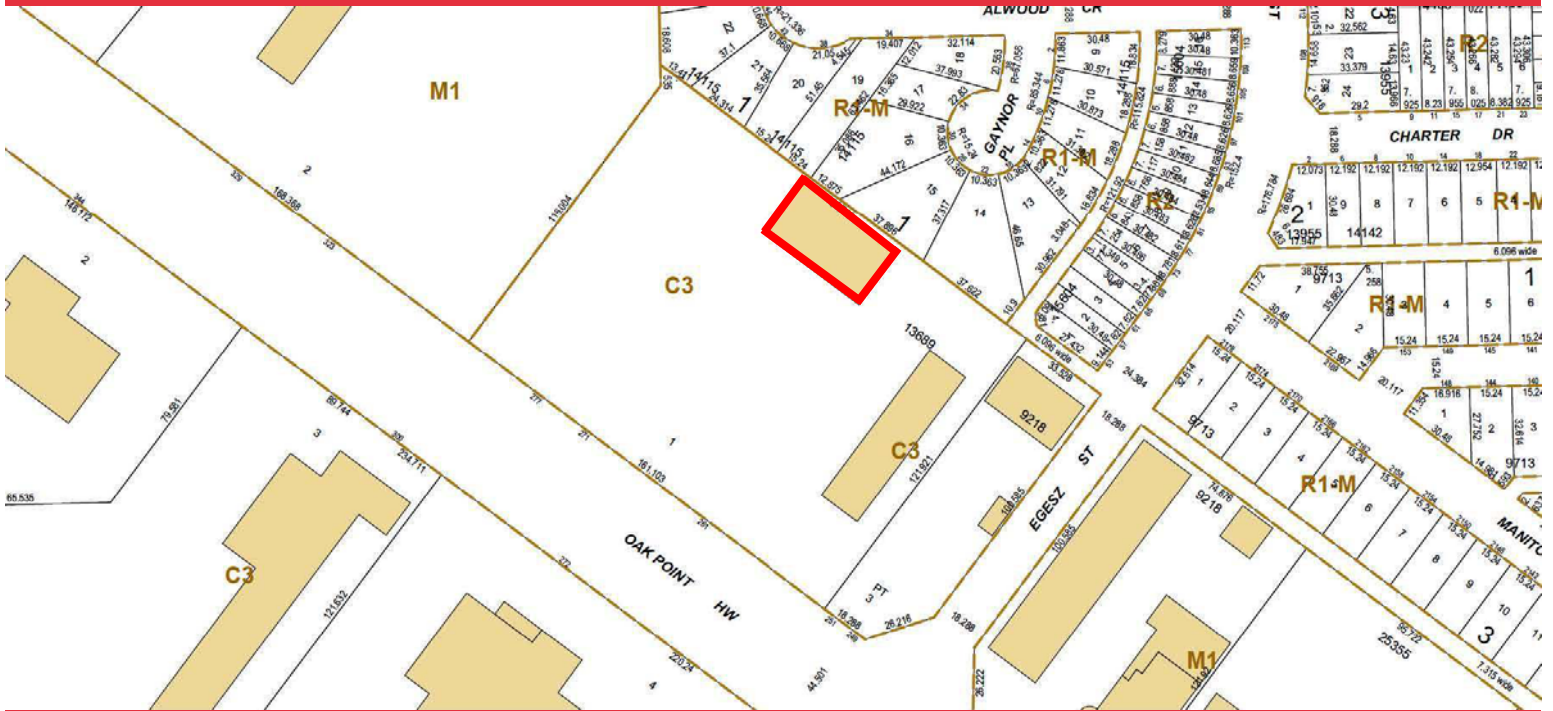

Murray Goodman

Sales & Leasing Associate
murray.goodman@dtzbarnicke.com

Direct Tel: 204 928 5009

Cell: 204 990 4800

DTZ Barnicke Winnipeg Ltd.

Sterling Lyon Business Park
Unit 5— 986 Lorimer Boulevard
Winnipeg, Manitoba R3P 0Z8

Tel: 204 928 5000

Cell: 204 990 4800

Fax: 204 928 5010

www.dtzbarnicke.com